

PLAN OF SUBDIVISION			EDITION 1	PS839284E
LOCATION OF LAND PARISH: PAKENHAM TOWNSHIP: SECTION: CROWN ALLOTMENT: 16 (PART), 17 (PART), & 18 (PART) CROWN PORTION: TITLE REFERENCE: Vol. Fol. LAST PLAN REFERENCE: Lot A on PS839249G POSTAL ADDRESS: Bridge Road (at time of subdivision) OFFICER 3809 MGA 2020 CO-ORDINATES: E: 361 000 ZONE: 55 (of approx centre of land in plan) N: 5758 390			COUNCIL NAME: CARDINIA SHIRE COUNCIL	
VESTING OF ROADS AND/OR RESERVES			NOTATIONS	
IDENTIFIER	COUNCIL/BODY/PERSON		Lots 201 to 215 may be affected by one or more restrictions. Refer to Creation of Restrictions A & B on Sheet 4 of this plan for details.	
Road R1 Reserve No. 1 Reserve No. 2	Cardinia Shire Council Cardinia Shire Council AusNet Electricity Services Pty Ltd			
NOTATIONS				
DEPTH LIMITATION: Does Not Apply				
SURVEY: This plan is based on survey. STAGING: This is not a staged subdivision. Planning Permit No. T200320 This survey has been connected to permanent marks no(s) PM528, PM527 In Proclaimed Survey Area no. N/A.				
OLIO ESTATE - Release No. 2 Area of Release: 1.082ha No. of Lots: 15 Lots and Balance Lot B				
EASEMENT INFORMATION				
LEGEND: A - Appurtenant Easement E - Encumbering Easement R - Encumbering Easement (Road)				
Easement Reference	Purpose	Width (Metres)	Origin	Land Benefited/In Favour Of
E-1	Sewerage	See Diag.	PS731532N	South East Water Corporation
 TAYLORS Urban Development Built Environments Infrastructure 8 / 270 Ferntree Gully Road, Notting Hill, Victoria, 3168 Tel: 61 3 9501 2800 Web: taylorstds.com.au		SURVEYORS FILE REF: Ref. 21915-S2 Ver. 3 Licensed Surveyor: MATTHEW WATT / Version No 3		ORIGINAL SHEET SIZE: A3 SHEET 1 OF 4

STROUD ROAD

COXON STREET

B
5.067ha

SEE SHEET 3

Reserve No. 1

Reserve No. 1
4535m²

Reserve No. 1

ENLARGEMENT 1

SCALE 1:125

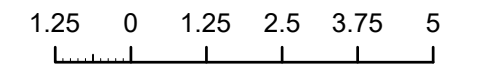

ENLARGEMENT 2

SCALE 1:400

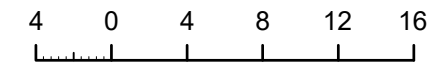

MGA2020 ZONE 55

TAYLORS

Urban Development | Built Environments | Infrastructure
8 / 270 Ferntree Gully Road, Notting Hill, Victoria, 3168
Tel: 61 3 9501 2800 | Web: taylorssds.com.au

SCALE 1:1250

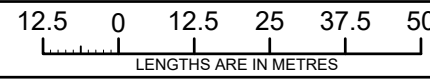

ORIGINAL SHEET SIZE: A3

Ref. 21915-S2 Ver. 3

SHEET 2

Licensed Surveyor:
MATTHEW WATT / Version No 3



COXON STREET

STREET

BASALT STREET R1 970m²

CRESCENT

FLAXLILLY

LIMESTONE LANE R1 400m²

TERRACOTTA WALK R1 347m²

Reserve No. 2 45m²

Reserve No. 1 SEE SHEET 2

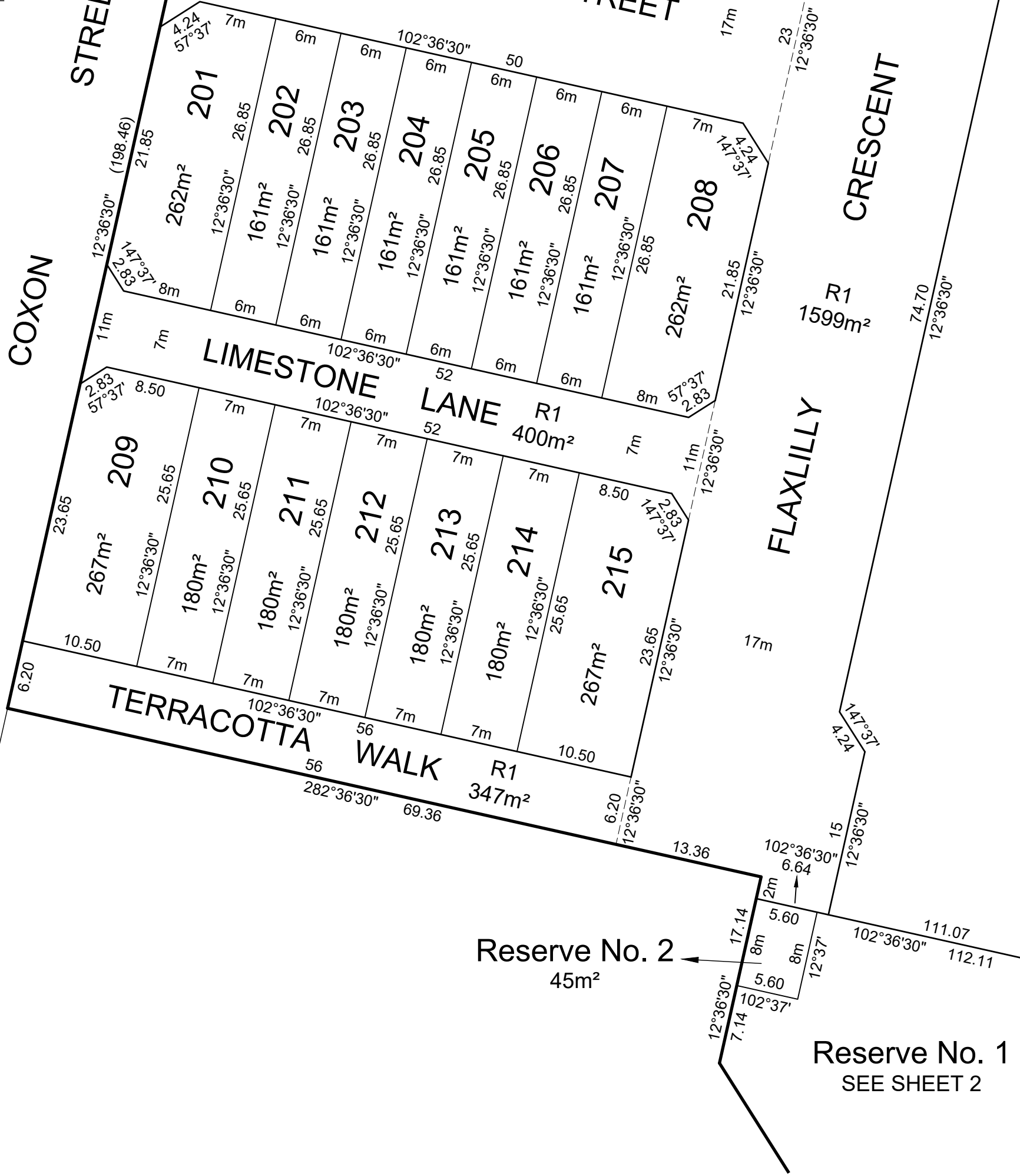

CREATION OF RESTRICTION A

The registered proprietors of the burdened land covenant with the registered proprietors of the benefited land as set out in the restriction with the intent that the burden of the restriction runs with and binds the burdened land and the benefit of the restriction is annexed to and runs with the benefited land.

BURDENED LAND: See Table 1

BENEFITED LAND: See Table 1

RESTRICTION:

The registered proprietor or proprietors for the time being of any burdened lot on this plan:

Must not build or permit to be built or remain on the lot any building other than a building which has been constructed in accordance with the Small Lot Housing Code incorporated into the Cardinia Planning Scheme unless a Planning Permit is granted by the Responsible Authority for a building that does not conform with the Small Lot Housing Code.

Expiry date: 01/03/2030

CREATION OF RESTRICTION B

The registered proprietors of the burdened land covenant with the registered proprietors of the benefited land as set out in the restriction with the intent that the burden of the restriction runs with and binds the burdened land and the benefit of the restriction is annexed to and runs with the benefited land.

BURDENED LAND: See Table 1

BENEFITED LAND: See Table 1

RESTRICTION:

The registered proprietor or proprietors for the time being of any burdened lot on this plan:

Must not present waste bins or hard waste for collection other than at the collection points as shown in the approved Waste Management Plan under Planning Permit No. T200320 and to the satisfaction of Cardinia Shire Council.

TABLE 1

BURDENED LOT No.	BENEFITING LOTS ON THIS PLAN
201	202
202	201, 203
203	202, 204
204	203, 205
205	204, 206
206	205, 207
207	206, 208
208	207
209	210
210	209, 211
211	210, 212
212	211, 213
213	212, 214
214	213, 215
215	214